

**GENERAL NOTES**

1. NIET ALLE CONSTRUCTIEVE STRAMEN EN REFERENTIES NAAR FRAGMENTEN ZIJN ZICHTBAAR. / FOR CLARITY, NOT ALL STRUCTURAL GRID LINES AND DETAILED CALLOUT REFERENCES ARE SHOWN.
2. ZIE ELEKTRA TEKENINGEN VOOR BLIKSEM AFLEIDING EN BEVESTIGINGSDETAILS. / REFER TO ELECTRICAL DRAWINGS FOR ROOF LIGHTNING PROTECTION LAYOUTS AND FIXING DETAILS.
3. ISOLATIE OP AFCHOT OM AFSCHOT TE CREËREN BIJ HEMELWATERAFVOER / TAPERED INSULATION AS PER SPECIFICATION TO BE USED TO FORM SLOPED CRICKETS TO DIRECT WATER TO ROOF DRAINS. INSTALL CRICKETS ADJACENT TO ALL LEAVES RAINWATER OUTLETS AND BEHIND ALL ROOF UPSTANDS OR IRREGULARITIES, FOR EXAMPLE, ROOF-MOUNTED EQUIPMENT, CURBS, RAILS AND HATCHES WHICH CROSS THE DOWN SLOPE FLOW OF WATER.
4. RIJGLINGSPLAN CONFORM LOCALE REGELGEVING / FINAL RAINWATER DESIGN TO BE PART OF LOCALIZATION PROCESS. ROOF CRICKETS, HOPPIES, RAIN WATER PIPES AND SCUPPER SIZING ARE BASED ON AN AGNOSTIC DESIGN AND LOCAL PRECIPITATION CONDITIONS TO BE CONSIDERED WHEN CALCULATING RAINWATER OUTLET SIZING AND QUANTITY REQUIREMENTS.
5. ISOLATIE OP AFSCHOT AFSTEMMEN MET DETAILS HEMELWATERAFVOER IN BOUWVOORBEREIDINGSFASE / ROOF CRICKETS TO BE COORDINATED WITH OUTLET DETAILS AT DETAILED DESIGN STAGE.

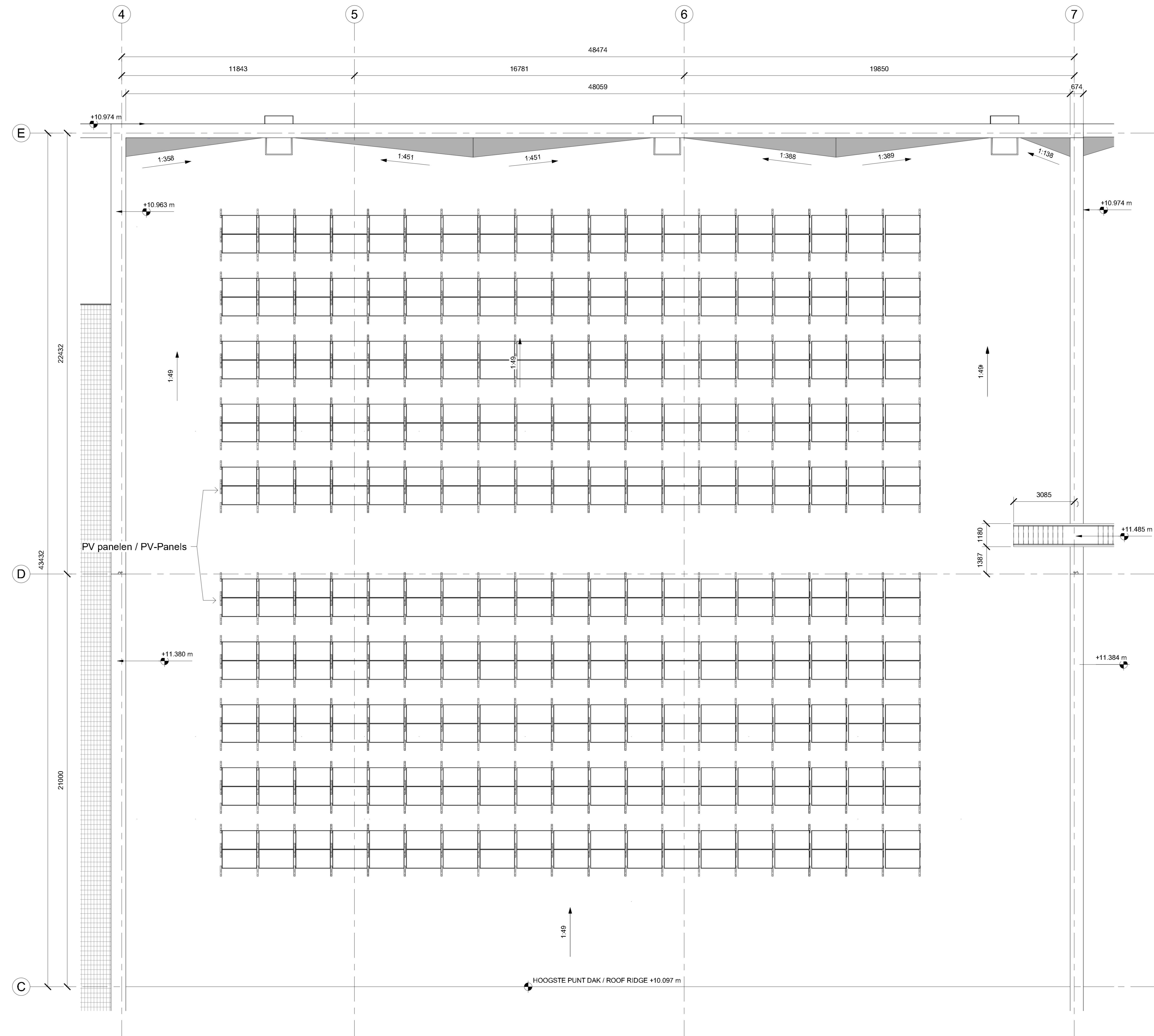

1 DC PLATTEGROND DAK - FASE 1 Zone A DH1A / DC ROOF PLAN - DAY 1 Zone A DH1A  
1 : 100

| Rc-WAARDEN / Rc-VALUES |                          |
|------------------------|--------------------------|
| GEVEL / FACADE         | 24,7 m <sup>2</sup> /K/W |
| DAK / ROOF             | 26,3 m <sup>2</sup> /K/W |
| VLOER / FLOOR          | 23,7 m <sup>2</sup> /K/W |

| Uc-WAARDEN / Uc-VALUES |                          |
|------------------------|--------------------------|
| GEVEL / FACADE         | 0,21 W/m <sup>2</sup> /K |
| DAK / ROOF             | 0,16 W/m <sup>2</sup> /K |
| VLOER / FLOOR          | 0,27 W/m <sup>2</sup> /K |
| BEGLAZING / GLAZING    | 1,65 W/m <sup>2</sup> /K |
| DEUR / DOOR            | 2,00 W/m <sup>2</sup> /K |

16-06-2022 14:24:04

|  |  |  |
|--|--|--|
| <b>BOUWKUNDIG / ARCHITECTURE:</b><br>Arup B.V.<br>Naritaweg 118<br>1043 CA<br>Amsterdam<br>The Netherlands | <b>CONSTRUCTIE / STRUCTURE:</b><br>Arup B.V.<br>Naritaweg 118<br>1043 CA<br>Amsterdam<br>The Netherlands | <b>INSTALLATIE TECHNISCH / MEP:</b><br>Arup B.V.<br>Naritaweg 118<br>1043 CA<br>Amsterdam<br>The Netherlands |
|--|--|--|



**AANVRAAG OMGEVINGSVERGUNNING / PERMITTING PACKAGE**  
(NIET VOOR UITVOERING / NOT FOR CONSTRUCTION)

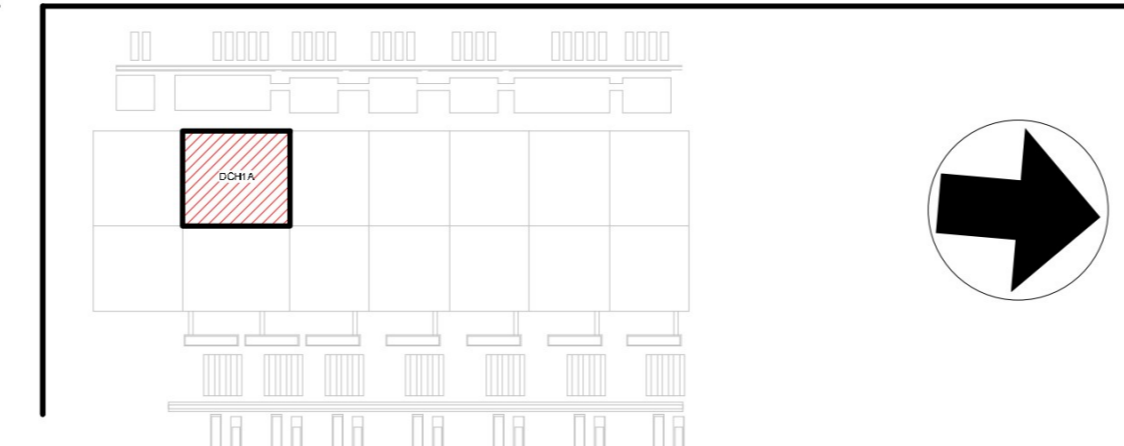

| REVISIE / REVISIONS |              |   |
|---------------------|--------------|---|
| NR / NO             | DATUM / DATE | OMSCHRIJVING / DESCRIPTION                            |
| 01                  | 2022-06-16   | Omgevingsvergunning Definitief / WAASO Permitt. Issue |

Getekend / Drawn By:  
Gecontroleerd / Checked By:  
Goedgekeurd / Approved By:

**DC1A ARCH**  
B. Haitzemastraat  
9672 DC Winschoten  
Netherlands  
Project Nr. / Project No.: 286821-00

**DC PLATTEGROND DAK - FASE 1 ZONE A / DC ROOF PLAN - DAY 1 ZONE A**  
Discipline / Discipline:  
ARCHITECTURE  
Schaal / Scale: As indicated Formaat / Sheet Size: A0

Tekening Nummer / Sheet Number:  
**1A-A-2020A-DCH1-R**  
Huidige Revisie / Current Rev: 0.1  
Fase / Phase: Permitting  
Model Naam / Model Name: 1A-ARCH  
Bestandsformaat / Native File Format: Revit V. 2022.1